



# Oak Grove

Cherry Orchard, Northampton



GROUND FLOOR  
450 sq.ft. (41.8 sq.m.) approx.

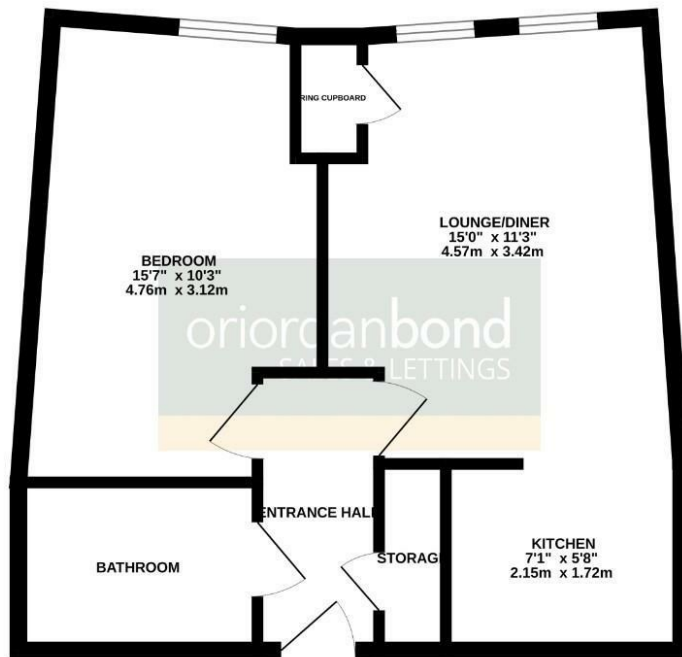

TOTAL FLOOR AREA : 450 sq.ft. (41.8 sq.m.) approx.  
Whilst every attempt has been made to ensure the accuracy of the floorplan contained here, measurements of doors, windows, rooms and any other items are approximate and no responsibility is taken for any error, omission or mis-statement. This plan is for illustrative purposes only and should be used as such by any prospective purchaser. The services, systems and appliances shown have not been tested and no guarantee as to their operability or efficiency can be given.  
Made with Metropix C2020

## Oak Grove

Cherry Orchard  
NN3 3JR

O'Riordan Bond is pleased to offer a double bedroom second floor apartment at Cherry Orchard, the development offers modern amenities and has good road links.

Accommodation comprises entrance hall and open to a fitted kitchen area, a good bathroom suite. Benefits include up to 2 allocated parking space. (B/450/-)

Leasehold Information: Lease Remaining 99 years per annum / Service Charge - £84 per month

### Additional information

- Council Tax Band: B
- Energy Efficiency Rating: C

### Viewing

Viewing strictly by appointment – details on request

### Disclaimer

O'Riordan Bond Estate Agents Limited are not solicitors and so cannot verify they are correct. Verification from their solicitor or surveyor should be sought.

O'Riordan Bond Abington East Sales  
01604 639007

abingtoneast@oriordanbond.co.uk